

LEOPARD 45

Lady Mara

The Catamaran Leopard 45 „Lady Mara“, built in 2020, is moored in Mallorca, Can Pastilla, - Spain. The yacht has 4 + 1 cabins, can accommodate 8 + 2 + 1 persons and has 4 + 1 toilets/showers.

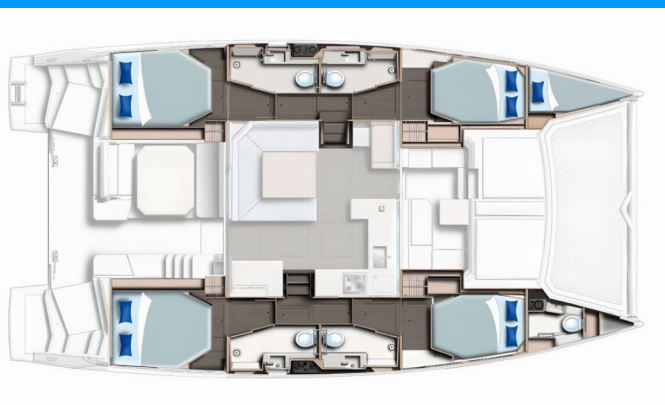

YACHT SPECIFICATIONS

Charter Base

Mallorca, Can Pastilla, Spain

Yacht ID

9735

Brand

Leopard

Name

Lady Mara

Production Year

2020

Length

13.72 m

Cabins

4 + 1

Berths

8 + 2 + 1

Head/Shower

4 + 1

STANDARD YACHT EQUIPMENT

Additional	Flag
Comfort	Cockpit cushions
Deck	Anchor light, Bimini top, Boat hook, Bosun's chair (Safe seat) (boatswain's chair), Bow pulpit, Cockpit table, Cockpit/stern, outside shower, Davit (Electric davits, stainless steel), Deck brush, Dinghy, Electric anchor windlass, Fenders, Floating rope, Gangway, Jerry cans for diesel, Main anchor, Mooring ropes (30 m), Pulpit seat, Spare anchor (Reserve, Auxiliary anchor), Sprayhood, Swimming ladder
Entertainment	Outdoor speakers, Radio CD mp3 player, Wi-Fi Internet
Galley	Freezer, Hot water, Kitchen utensils (Galley equipment, cutlery), Microwave, Nescaffe Dolce Gusto Coffee Maker (Capsule machine), Oven, Pressurized water system, Refrigerator (212 l), Sink, Stove, Wine glasses
Interior	Ceiling lights, Clock, Electric fans in cabins (and in the lounge), Lowerable salon table, Safe, Yacht keys
Navigation	AIS (Transmit and receive AIS), Autopilot (Raymarine p70), Binoculars, Compass, Echosounder/Depthsounder (Raymarine i70), GPS chart plotter - cockpit (Raymarine Axiom 9), Navigation (Nautical) charts and nautical guide, Navigation/position Lights, Triangles, Wind instrument/Anemometer (Raymarine i70), Windex
Safety	Automatic Inflatable Life Jacket, Black Water Tank, Distress signals, Fire extinguisher, First aid kit, Flashlight, Fog horn, Life belts (Safety harness), Life buoy + Flashing light, Liferaft, Set of tools, VHF radio, Wire (shroud) cutter
Sails	Halyard winches, Lazy bag, Lazy jacks, Main sheet winches
Yacht electrics	12V Socket, 220V socket, Adapter, Air Conditioning (2x Cruisair 220V - 16.000 BTU), Battery charger (220 V), Bilge pump - Electric, Generator (Northern Lights 9 kW (1760 h)), Heating (Dometic, Diesel, in all cabins), Inverter (12 V / 220 V), Shore connection 220 V (25 m), Solar panels (2x Sunware), Watermaker - desalinator

PRICE / WEEKS

25.04. - 02.05.2026 Booked	02.05. - 09.05.2026 3.300 € 4.400 €	09.05. - 16.05.2026 5.325 € 7.100 €	16.05. - 23.05.2026 Booked
23.05. - 30.05.2026 6.150 € 8.200 €	30.05. - 13.06.2026 Booked	13.06. - 20.06.2026 Booked	20.06. - 27.06.2026 Booked
27.06. - 04.07.2026 Booked	04.07. - 11.07.2026 Booked	11.07. - 18.07.2026 9.855 € 10.950 €	18.07. - 25.07.2026 9.855 € 10.950 €
25.07. - 01.08.2026 9.855 € 10.950 €	01.08. - 15.08.2026 Booked	15.08. - 29.08.2026 Booked	29.08. - 05.09.2026 9.855 € 10.950 €
05.09. - 12.09.2026 Booked	12.09. - 19.09.2026 Booked	19.09. - 26.09.2026 Booked	26.09. - 03.10.2026 7.380 € 8.200 €
03.10. - 10.10.2026 Booked	10.10. - 17.10.2026 6.390 € 7.100 €	17.10. - 24.10.2026 3.960 € 4.400 €	24.10. - 31.10.2026 3.960 € 4.400 €
31.10. - 07.11.2026 3.960 € 4.400 €			



WEB

najachty.pl

PHONE

+48 882 071 532

E-MAIL

biuro@najachty.pl

NAJACHTY

ul. Pi. Świętej Małgorzaty 1-2/42B, 58-100, Świdnica, Poland



PRICE / WEEKS

08.11. - 26.03.2027

Booked



WEB

najachty.pl

PHONE

+48 882 071 532

E-MAIL

biuro@najachty.pl

NAJACHTY

ul. Pi. Świętej Małgorzaty 1-2/42B, 58-100, Świdnica, Poland

