

OCEANIS 40.1

Namaka Ekolu

The Sailing yacht Oceanis 40.1 „Namaka Ekolu“, built in 2026, is moored in Palma de Mallorca, Marina Naviera Balear, - Spain.

The yacht has 4 cabins, can accomodate 8 + 2 persons and has 2 toilets/showers.

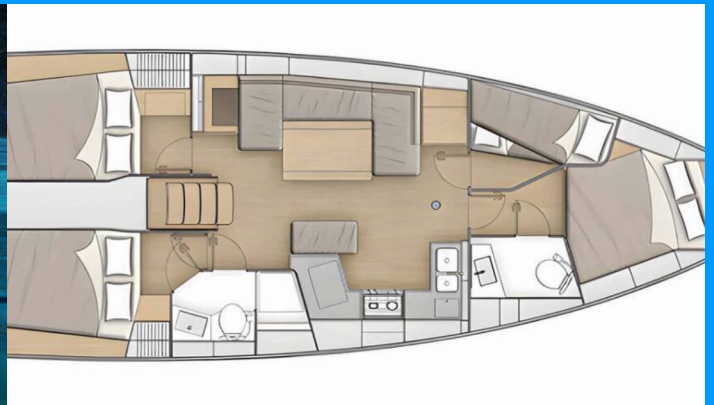

YACHT SPECIFICATIONS

Charter Base

**Palma de Mallorca, Marina Naviera
Balear, Spain**

Yacht ID

9608

Brand

Bénéteau

Name

Namaka Ekolu

Production Year

2026

Length

12.87 m

Cabins

4

Berths

8 + 2

Max. Passengers

10

Head/Shower

2

STANDARD YACHT EQUIPMENT

Additional

Flag

Comfort

Cockpit cushions

Deck

Anchor light, Anchor with chain, Bathing platform (Teak), Bimini top, Boat hook, Bosun's chair (Safe seat) (boatswain's chair), Bow pulpit, Cockpit table, Cockpit/stern, outside shower, Deck brush, Dinghy, Electric anchor windlass, Fenders, Jerry cans for diesel, Mooring ropes, Plastic bucket, Spare anchor (Reserve, Auxiliary anchor), Spotlight / Headlights, Sprayhood, Swimming ladder

Entertainment

Outdoor speakers, Radio, Wi-Fi Internet

Galley

Coffee machine (Dolce Gusto Capsule Machine), Gas cookers, Hot water, Kitchen utensils (Galley equipment, cutlery), Oven, Pressurized water system, Refrigerator

Interior

Clock, Convertible table in salon, Electric fans, Electric toilet, Heater / Blower, Safe, Yacht keys

Navigation

AIS, Autopilot, Binoculars, Bow thruster, Compass, Composite steering wheels, Depthsounder, GPS chart plotter - cockpit, Hand bearing compass, Log, Navigation (Nautical) charts and nautical guide, Navigation/position Lights, Speedometer (Speed log), Triangles, Wind instrument/Anemometer, Windex

Safety

Automatic Inflatable Life Jacket, Black Water Tank, Distress signals, Emergency tiller, Fire extinguisher, First aid kit, Flashlight, Fog horn, Guard rail, Horseshoe lifebuoy, Liferaft, Set of tools, VHF radio, Wire (shroud) cutter

Yacht electrics

12V Socket, 220V socket, Adapter, Bilge pump - Electric, Converter 230V/12V, Shore power cable, USB sockets (Double USB port in the salon and in all cabins)

PRICE / WEEKS

25.04. - 02.05.2026 Booked	02.05. - 09.05.2026 Booked	09.05. - 16.05.2026 Booked	16.05. - 23.05.2026 Booked
23.05. - 06.06.2026 Booked	06.06. - 13.06.2026 Booked	13.06. - 20.06.2026 Booked	20.06. - 27.06.2026 Booked
27.06. - 04.07.2026 Booked	04.07. - 11.07.2026 Booked	11.07. - 18.07.2026 4.725 € 5.250 €	18.07. - 25.07.2026 4.725 € 5.250 €
25.07. - 01.08.2026 Booked	01.08. - 08.08.2026 Booked	08.08. - 15.08.2026 Booked	15.08. - 22.08.2026 Booked
22.08. - 29.08.2026 4.725 € 5.250 €	29.08. - 05.09.2026 Booked	05.09. - 12.09.2026 Booked	12.09. - 03.10.2026 Booked
03.10. - 10.10.2026 Booked	10.10. - 17.10.2026 On option	17.10. - 24.10.2026 2.430 € 2.700 €	24.10. - 31.10.2026 2.430 € 2.700 €
31.10. - 07.11.2026 2.430 € 2.700 €			



WEB

najachty.pl

PHONE

+48 882 071 532

E-MAIL

biuro@najachty.pl

NAJACHTY

ul. Pi. Świętej Małgorzaty 1-2/42B, 58-100, Świdnica, Poland



PRICE / WEEKS

01.01. - 26.03.2027

Booked



WEB

najachty.pl

PHONE

+48 882 071 532

E-MAIL

biuro@najachty.pl

NAJACHTY

ul. Pi. Świętej Małgorzaty 1-2/42B, 58-100, Świdnica, Poland

