

NAUTITECH 40 OPEN NEW

Whale Symphony

The Catamaran Nautitech 40 open NEW „Whale Symphony“, built in 2018, is moored in Tribunj D-Marin, - Croatia. The yacht has 4 + 2 cabins, can accommodate 8 + 2 persons and has 2 toilets/showers.

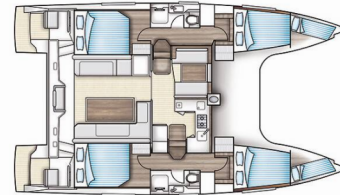

YACHT SPECIFICATIONS

Charter Base

Tribunj D-Marin, Croatia

Yacht ID

9544

Brand

Bavaria Yachtbau

Name

Whale Symphony

Production Year

2018

Length

11.99 m

Cabins

4 + 2

Berths

8 + 2

Head/Shower

2

STANDARD YACHT EQUIPMENT

Comfort

Bed linen, Cockpit cushions

Deck

Anchor line, Anchor swivel, Bathing platform, Bimini top (at helm stand), Black ball, Black conus, Boat hook, Bosun's chair (Safe seat) (boatswain's chair), Canister for water, Chairs, Cockpit full tent, Cockpit table, Cockpit/stern, outside shower, Davit, Dinghy, Dinghy (byboat) pump, Electric anchor windlass, Fenders (wood), Gangway, Hawser, Impeller, V-belt, oilfilter, Jerry cans for diesel, Main anchor (Jambo 22 kg), Mooring ropes, Plastic bucket, Remote control for anchor winch with chain counter at helm, Repair box for dinghy, Round/globular fender, Spare anchor (Reserve, Auxiliary anchor), Spotlight / Headlights, Spring line, Water hose

Entertainment

Outdoor speakers, Radio (Fusion Marine: USB, AUX, Bluetooth), Wi-Fi Internet

Galley

Hot water, Kitchen utensils (Galley equipment, cutlery), Refrigerator (Pantry 130l + Cockpit 65l + icebox 55l)

Interior

Barometer, Clock, Electric fans in cabins, Electric toilet (New 2022), Inside shower

Navigation

3 blade folding propeller, AIS (B&G), Autopilot (B&G), Binoculars with integrated compass, GPS chart plotter - cockpit (B&G Zeus 3), Harbour guides, Logge/Lot/Speed/Wind (B&G), Navigation (Nautical) charts and nautical guide, Navigation set, Radar (B&G), Radar reflector

Safety

Distress flare box, Fire extinguisher, First aid kit, Flashlight, Fog horn, Life belts (Safety harness), Life buoy + Flashing light, Liferaft, Self inflating life vest, Set of tools, VHF radio (B&G V90), Wire (shroud) cutter

Sails

Electric winch, Gennaker-device, Lazy bag, Lazy jacks

Yacht electrics

Battery charger, Heating (5 kW), Inverter (WAECO 900 Watt), Shore connection 220 V, Solar panels (PHOTOVOLTAIC, 400 Watt)

PRICE / WEEKS

23.04. - 26.04.2026 Booked	02.05. - 09.05.2026 1.140 € 2.000 €	09.05. - 16.05.2026 Booked	16.05. - 23.05.2026 1.664 € 2.600 €
23.05. - 30.05.2026 Booked	30.05. - 06.06.2026 Booked	06.06. - 13.06.2026 Booked	13.06. - 20.06.2026 3.268 € 4.300 €
20.06. - 27.06.2026 3.575 € 5.500 €	27.06. - 04.07.2026 Booked	04.07. - 11.07.2026 On option	11.07. - 18.07.2026 4.130 € 5.900 €
18.07. - 25.07.2026 Booked	25.07. - 01.08.2026 4.221 € 6.700 €	01.08. - 08.08.2026 4.154 € 6.700 €	08.08. - 15.08.2026 4.154 € 6.700 €
15.08. - 22.08.2026 3.886 € 6.700 €	22.08. - 29.08.2026 3.819 € 6.700 €	29.08. - 05.09.2026 3.416 € 6.100 €	05.09. - 12.09.2026 3.540 € 5.900 €
12.09. - 19.09.2026 On option	19.09. - 26.09.2026 Booked	26.09. - 03.10.2026 On option	03.10. - 10.10.2026 On option
10.10. - 17.10.2026 Booked	17.10. - 24.10.2026 1.335 € 1.500 €	31.10. - 31.12.2026 Booked	



WEB

najachty.pl

PHONE

+48 882 071 532

E-MAIL

biuro@najachty.pl

NAJACHTY

ul. Pi. Świętej Małgorzaty 1-2/42B, 58-100, Świdnica, Poland

