

# BAVARIA CRUISER 41

Erifyli

The Sailing yacht Bavaria Cruiser 41 „Erifyli“, built in 2015, is moored in Kos, Kos Marina, - Greece. The yacht has 3 cabins, can accommodate 6 + 2 persons and has 2 toilets/showers.

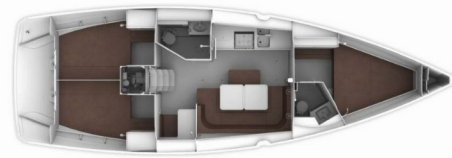

## YACHT SPECIFICATIONS

Charter Base

**Kos, Kos Marina, Greece**

Yacht ID

**940**

Brand

**Bavaria Yachtbau**

Name

**Erifyli**

Production Year

**2015**

Length

**12.35 m**

Cabins

**3**

Berths

**6 + 2**

Max. Passengers

**8**

Head/Shower

**2**

## STANDARD YACHT EQUIPMENT

Additional

Flag

Comfort

Blankets, Pillows

Deck

Anchor with chain, Bathing platform, Bimini top, Boat hook, Bosun's chair (Safe seat) (boatswain's chair), Cockpit/stern, outside shower, Dinghy (inflatable), Electric anchor windlass, Floating rope, Gangway (Inox), Inox Boarding Ladder, Main anchor, Main Deck Compass, Mooring ropes (10, 20, 50 m), Repair box for dinghy, Reserve motor oil, Spare anchor (Reserve, Auxiliary anchor), Sprayhood

Entertainment

Fins, Indoor speakers, Mask, Outdoor speakers, Radio CD player

Galley

Gas bottles, Gas cookers, Hot water, Kitchen utensils (Galley equipment, cutlery), Oven, Refrigerator, Sink

Interior

Barometer, Clock, Convertible table, Coolbox, Electric toilet, Hand water pump

Navigation

Autopilot, Binoculars, Bow thruster, Depthsounder, Divider, nautic chart, Echosounder/Depthsounder, GPS chart plotter, GPS chart plotter - cockpit, Log/speed instrument, Nautical charts, Navigation (Nautical) charts and nautical guide, Navigation set, Parallel ruler, Speedometer (Speed log)

Safety

Distress flare box, Engine spare parts, Fire extinguisher, First aid kit, Fog horn, Horseshoe lifebuoy, Life belts (Safety harness), Life jackets, Liferaft, Oars (Paddles), Repair kit (for sails), Set of tools, Torch, VHF radio, Wire (shroud) cutter

Yacht electrics

Batteries, Bilge pump - Electric, Inverter, Service batteries, Shore power cable, Solar panels (2018), Start battery

## PRICE / WEEKS

02.05. - 09.05.2026 Booked	09.05. - 16.05.2026 Booked	16.05. - 23.05.2026 1.645 € <del>2.350 €</del>	23.05. - 30.05.2026 Booked
30.05. - 06.06.2026 Booked	06.06. - 20.06.2026 Booked	20.06. - 27.06.2026 2.880 € <del>3.200 €</del>	27.06. - 04.07.2026 2.880 € <del>3.200 €</del>
04.07. - 11.07.2026 2.800 € <del>3.500 €</del>	11.07. - 18.07.2026 2.800 € <del>3.500 €</del>	18.07. - 25.07.2026 2.800 € <del>3.500 €</del>	25.07. - 01.08.2026 2.800 € <del>3.500 €</del>
01.08. - 15.08.2026 Booked	15.08. - 22.08.2026 3.160 € <del>3.950 €</del>	22.08. - 29.08.2026 2.800 € <del>3.500 €</del>	29.08. - 05.09.2026 3.220 € <del>3.500 €</del>
05.09. - 12.09.2026 Booked	12.09. - 26.09.2026 Booked	26.09. - 03.10.2026 Booked	03.10. - 10.10.2026 Booked
10.10. - 17.10.2026 2.565 € <del>2.850 €</del>	17.10. - 24.10.2026 1.800 € <del>2.000 €</del>	24.10. - 31.10.2026 1.800 € <del>2.000 €</del>	31.10. - 07.11.2026 1.800 € <del>2.000 €</del>
07.11. - 14.11.2026 1.800 € <del>2.000 €</del>	15.11. - 31.12.2026 Booked		



### WEB

najachty.pl

### PHONE

+48 882 071 532

### E-MAIL

biuro@najachty.pl

### NAJACHTY

ul. Pi. Świętej Małgorzaty 1-2/42B, 58-100, Świdnica, Poland

