

FONTAINE PAJOT ELBA 45

Protea

The Catamaran Fontaine Pajot Elba 45 „Protea“, built in 2025 , is moored in Marina Frapa, Rogoznica, Rogoznica - Croatia.

The yacht has 3 cabins, can accomodate 6 + 2 persons and has 3 toilets/showers.

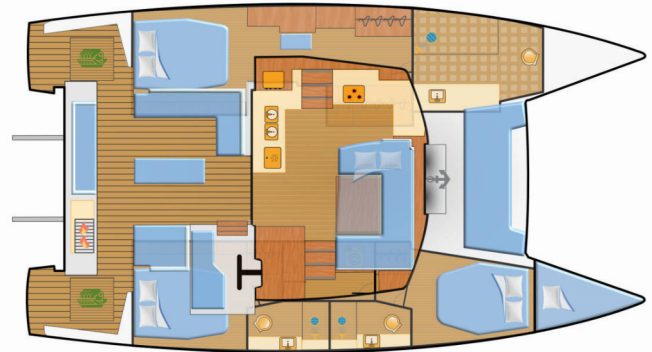

YACHT SPECIFICATIONS

Charter Base

Marina Frapa, Rogoznica, Croatia

Yacht ID

8629

Brand

Fountaine Pajot

Name

Protea

Production Year

2025

Length

13.45 m

Cabins

3

Berths

6 + 2

Max. Passengers

7

Head/Shower

3

STANDARD YACHT EQUIPMENT

Additional

Flag

Comfort

Cockpit cushions, Sundeck cushions

Deck

Anchor light, Bathing platform (Flexiteak), Bilge pump - Mechanic, Bimini top, Boat hook, Bosun's chair (Safe seat) (boatswain's chair), Cockpit fridge, Cockpit table, Cockpit/stern, outside shower, Deck brush, Dinghy, Electric anchor windlass, Fenders (6 - 8), Gangway, Impeller, Jerry cans for diesel, Main anchor (50 m chain), Mooring ropes (30 m), Plastic bucket, Sailor's knife, Spare anchor (Reserve, Auxiliary anchor), Sprayhood, Swimming ladder, Teak cockpit (Flexiteak)

Entertainment

Mask and snorkel (1 Set), TV (With DVBT2 and DVD)

Galley

Hot water, Kitchen utensils (Galley equipment, cutlery), Refrigerator (2. refrigerator with 90 litres), Stove (Gas)

Interior

Barometer, Clock, Dryer (Washing machine/dryer 5 kg 220V), Electric fans (In all cabins and salon), Slatted frame (under all mattresses), Washing machine (Washing machine/dryer 5 kg 220V)

Navigation

AIS, Autopilot, Binoculars, Bow thruster, Compass, Folding propeller (3 sheet), GPS, GPS chart plotter, Navigation (Nautical) charts and nautical guide, Navigation/position Lights, Radar, Triangles, Wind/speed/depth instruments, Windex

Safety

Automatic Inflatable Life Jacket, Black Water Tank, Distress signals, Emergency tiller, Fire axe, Fire extinguisher, First aid kit, Flashlight, Fog horn, Guard rail, Life buoy + Flashing light, Lifelines, Liferaft, Set of tools, VHF radio, Wire (shroud) cutter

Sails

Electric winch, Gennaker-device, Halyard winches, Lazy bag, Lazy jacks, Main sheet winches

Yacht electrics

12V Socket, 220V socket, Air Conditioning (28.000BTU), Bilge pump - Electric, Generator, Heating (Webasto), Inverter (2.000 W), Shore power cable (220 V / 25 m), Solar panels

PRICE / WEEKS

25.04. - 02.05.2026 2.730 € 3.500 €	02.05. - 09.05.2026 2.730 € 3.500 €	09.05. - 16.05.2026 3.900 € 5.000 €	16.05. - 04.07.2026 Booked
04.07. - 11.07.2026 On option	11.07. - 18.07.2026 7.956 € 10.200 €	18.07. - 25.07.2026 Booked	25.07. - 15.08.2026 Booked
15.08. - 22.08.2026 7.956 € 10.200 €	22.08. - 29.08.2026 7.956 € 10.200 €	29.08. - 05.09.2026 Booked	05.09. - 12.09.2026 7.293 € 9.350 €
12.09. - 03.10.2026 Booked	03.10. - 10.10.2026 3.900 € 5.000 €	10.10. - 17.10.2026 Booked	17.10. - 24.10.2026 2.730 € 3.500 €
24.10. - 31.10.2026 2.730 € 3.500 €	31.10. - 07.11.2026 2.730 € 3.500 €		



WEB

najachty.pl

PHONE

+48 882 071 532

E-MAIL

biuro@najachty.pl

NAJACHTY

ul. Pi. Świętej Małgorzaty 1-2/42B, 58-100, Świdnica, Poland



PRICE / WEEKS

07.11. - 14.11.2026 2.730 € 3.500 €	14.11. - 21.11.2026 3.500 €	21.11. - 28.11.2026 3.500 €	28.11. - 05.12.2026 3.500 €
05.12. - 12.12.2026 3.500 €	12.12. - 19.12.2026 3.500 €	19.12. - 26.12.2026 3.500 €	01.01. - 26.03.2027 Booked



WEB

najachty.pl

PHONE

+48 882 071 532

E-MAIL

biuro@najachty.pl

NAJACHTY

ul. Pi. Świętej Małgorzaty 1-2/42B, 58-100, Świdnica, Poland

