

BALI 4.8

WHITNEY

The Catamaran Bali 4.8 „WHITNEY“, built in 2024, is moored in Guadeloupe, La Marina Bas du Fort, - Caribbean. The yacht has 6 + 1 cabins, can accomodate 12 + 1 persons and has 6 + 1 toilets/showers.

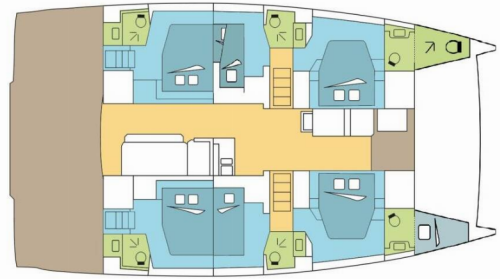

YACHT SPECIFICATIONS

Charter Base

**Guadeloupe, La Marina Bas du Fort,
Caribbean**

Yacht ID

8355

Brand

Catana

Name

WHITNEY

Production Year

2024

Length

14.86 m

Cabins

6 + 1

Berths

12 + 1

Max. Passengers

13

Head/Shower

6 + 1

STANDARD YACHT EQUIPMENT

Comfort

Forward cockpit cushions (seats and backrests),
Helmstation seat cushions (seat and backrest), Mosquito
nets

Deck

Bar (integrated in salon table with reversible tray), Bimini
top, Cockpit table (fixed), Cockpit/stern, outside shower
(Hot and cold water), Davit (electrical), Dinghy (Lifting
system), Electric anchor windlass (1700W), Fly sunbathing
area (sunbathing cushions with backrests), Flybridge (table
with 2 telescopic legs), Forward cockpit (and transom
courtesy lighting), Grill/Barbecue/Plancha (plancha with gas
installation), Outboard engine, Remote control for anchor
winch with chain counter at helm, Seats for aft bench (seats
and backrests), Spring cleats, Swimming ladder (with large
handles and teak steps)

Entertainment

Fusion radio (6HP Bluetooth (salon, Flybridge and front
cockpit))

Galley

Electric hob for cooking (4 burners cooking hob in glass and
large capacity oven instead of standard size), Freezer (635L
with chilled water, ice maker and dedicated inverter),
Microwave (Oven 220V), Oven (Gaz), Water pump (sea
water pump at galley & anchor)

Interior

Electric fans (1 fan per cabin and forepeak), Electric toilet
(freshwater), Indirect lighting in cabins and cockpit (& in
saloon), Upholstery (Indoor and outdoor)

Navigation

AIS, Autopilot (Raymarine, P70S), GPS chart plotter -
cockpit (Raymarine, AXIOM 7, MULTII70S),
Wind/speed/depth instruments

Safety

VHF radio (RAY 63)

Sails

Electric main sail winch, Lazy bag, Lazy jacks

Yacht electrics

Air Conditioning (In hulls 220V / 50HZ), Alternator (12V
125A), Battery charger (80 AMP), Generator (11KW 50HZ
with soundshield and remote control 220V), Inverter (12 /
220V - 2000VA), Service batteries (2 12V extra of 130 amp),
Solar panels (5 x 100W), Watermaker - desalinator (220V
240L/H)

PRICE / WEEKS

25.04. - 09.05.2026

Booked

09.05. - 17.05.2026

Booked

22.05. - 28.05.2026

Booked

03.06. - 08.06.2026

Booked

11.07. - 25.07.2026

Booked

03.08. - 17.08.2026

Booked

30.08. - 25.09.2026

Booked

31.10. - 28.11.2026

Booked



WEB

najachty.pl

PHONE

+48 882 071 532

E-MAIL

biuro@najachty.pl

NAJACHTY

ul. Pi. Świętej Małgorzaty 1-2/42B, 58-100, Świdnica, Poland



PRICE / WEEKS

28.11. - 12.12.2026

Booked

19.12. - 26.12.2026

12.341 € ~~12.990 €~~

29.12. - 13.01.2027

Booked



WEB

najachty.pl

PHONE

+48 882 071 532

E-MAIL

biuro@najachty.pl

NAJACHTY

ul. Pi. Świętej Małgorzaty 1-2/42B, 58-100, Świdnica, Poland

