

BALI 4.8

NEWTON

The Catamaran Bali 4.8 „NEWTON“, built in 2024, is moored in Guadeloupe, La Marina Bas du Fort, - Caribbean. The yacht has 6 + 1 cabins, can accomodate 12 + 1 persons and has 6 + 1 toilets/showers.

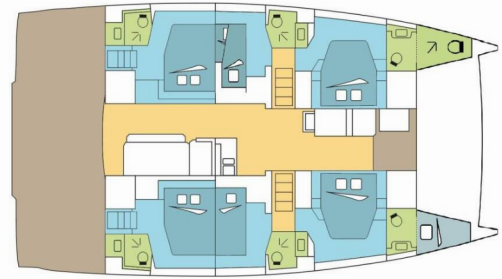

YACHT SPECIFICATIONS

Charter Base

**Guadeloupe, La Marina Bas du Fort,
Caribbean**

Yacht ID

8353

Brand

Catana

Name

NEWTON

Production Year

2024

Length

14.86 m

Cabins

6 + 1

Berths

12 + 1

Max. Passengers

13

Head/Shower

6 + 1

STANDARD YACHT EQUIPMENT

Comfort

Forward cockpit cushions (seats and backrests), Helmstation seat cushions (seat and backrest), Mosquito nets

Deck

Bar (integrated in salon table with reversible tray), Cockpit table (fixed), Cockpit/stern, outside shower (Hot and cold cockpit shower), Davit (electrical), Dinghy (Lifting system), Electric anchor windlass (1700W), Fly sunbathing area (sunbathing cushions with backrests), Flybridge (table with 2 telescopic legs), Forward cockpit (and transom courtesy lighting), Grill/Barbecue/Plancha (plancha with gas installation), Outboard engine, Remote control for anchor winch with chain counter at helm, Seats for aft bench (seats and backrests), Spring cleats, Swimming ladder (with large handles and teak steps)

Entertainment

Fusion radio (6HP Bluetooth (salon, Flybridge and front cockpit))

Galley

Electric hob for cooking (4 burners cooking hob in glass and large capacity oven instead of standard size), Freezer (635L with chilled water, ice maker and dedicated inverter), Kitchen utensils (Galley equipment, cutlery), Oven (Gaz), Refrigerator, Stove

Interior

Curtains (External roof curtains for sun protection of the saloon), Electric fans (1 fan per cabin and forepeak), Electric toilet (freshwater), Indirect lighting in cabins and cockpit (& in saloon), Upholstery (Indoor and outdoor)

Navigation

AIS, Autopilot (Raymarine, P70S), GPS chart plotter - cockpit (Raymarine, AXIOM 7, MULTI I70S), Wind/speed/depth instruments

Safety

VHF radio (RAY 63)

Sails

Electric main sail winch (& for solent), Electric winch (for head sails), Lazy bag, Lazy jacks

Yacht electrics

Air Conditioning (In hulls & In salon 220V / 50HZ plus supplement 220V/60HZ), Alternator (12V 125A), Battery charger (80 AMP), Generator (12KW 60HZ with soundshield and remote control 220V), Inverter (12 / 220V - 2000VA), Service batteries (2 12V extra of 130 amp), Solar panels (5 x 100W), Watermaker - desalinator (220V 240L/H)

PRICE / WEEKS

02.05. - 09.05.2026

Booked

09.05. - 16.05.2026

Booked

22.05. - 28.05.2026

Booked

03.06. - 08.06.2026

Booked

22.06. - 09.07.2026

Booked

25.07. - 08.08.2026

Booked

30.08. - 25.09.2026

Booked

31.10. - 07.11.2026

Booked

07.11. - 21.11.2026

Booked

21.11. - 28.11.2026

Booked

29.11. - 06.12.2026

Booked



WEB

najachty.pl

PHONE

+48 882 071 532

E-MAIL

biuro@najachty.pl

NAJACHTY

ul. Pi. Świętej Małgorzaty 1-2/42B, 58-100, Świdnica, Poland



PRICE / WEEKS

19.12. - 02.01.2027

Booked



WEB

najachty.pl

PHONE

+48 882 071 532

E-MAIL

biuro@najachty.pl

NAJACHTY

ul. Pi. Świętej Małgorzaty 1-2/42B, 58-100, Świdnica, Poland

