

SUN ODYSSEY 380

Lidija

The Sailing yacht Sun Odyssey 380 „Lidija“, built in 2023, is moored in Marina Tehnomont Veruda, Pula, Pula - Croatia. The yacht has 3 cabins, can accomodate 6 + 2 persons and has 2 toilets/showers.

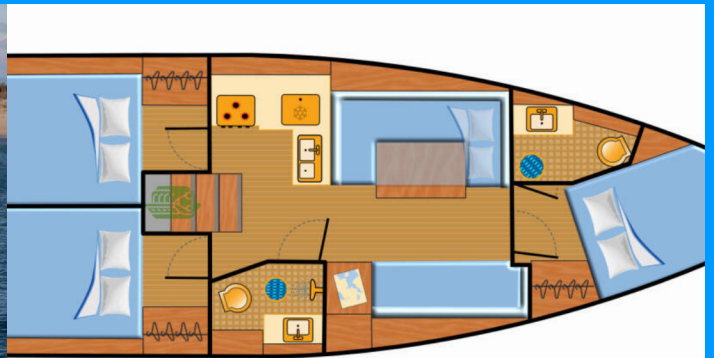

Werftbild
Details können abweichen
! © 2023 Jeanneau Group - details may vary

YACHT SPECIFICATIONS

Charter Base

**Marina Tehnomont Veruda, Pula,
Croatia**

Yacht ID

8287

Brand

Jeanneau

Name

Lidija

Production Year

2023

Length

11.22 m

Cabins

3

Berths

6 + 2

Max. Passengers

8

Head/Shower

2

STANDARD YACHT EQUIPMENT

Additional	Flag
Comfort	Cockpit cushions, Mosquito nets (in the owner's cabin)
Deck	Anchor light, Anchor with chain (50m), Bathing platform (Teak), Bimini top, Boat hook, Bosun's chair (Safe seat) (boatswain's chair), Cockpit table, Cockpit/stern, outside shower (warm/cold), Deck brush, Dinghy, Electric anchor windlass, Fenders, Gangway, Impeller, Jerry cans for diesel, Mooring ropes (4 x 30m), Spare anchor (Reserve, Auxiliary anchor), Sprayhood, Swimming ladder, Teak cockpit
Entertainment	Radio (with Aux/Bluetooth + speakers), Wi-Fi Internet
Galley	Hot water, Kitchen utensils (Galley equipment, cutlery), Oven, Pressurized water system, Refrigerator (100 l), Sink (in the pantry), Stove
Interior	Ambiental lighting, Barometer, Clock, Electric fans in cabins (and in the lounge), Heater / Blower (230 V), Lowerable salon table, Safe, Yacht keys
Navigation	Autopilot, Bow thruster, Compass, Divider, nautic chart, Echosounder/Depthsounder, GPS chart plotter, Hand bearing compass, Log, Navigation (Nautical) charts and nautical guide, Navigation/position Lights, Triangles, Wind instrument/Anemometer, Windex
Safety	Automatic Inflatable Life Jacket, Black Water Tank, Distress signals, Emergency tiller, Fire axe, Fire extinguisher, First aid kit, Fog horn, Guard rail, Horseshoe lifebuoy, Life buoy + Flashing light, Lifelines, Liferaft, Set of tools, VHF radio, Wire (shroud) cutter
Sails	Lazy bag, Lazy jacks, Winch
Yacht electrics	12V Socket, 220V socket, Bilge pump - Electric, Converter 220V/12V, Heating (diesel), Inverter, Shore power cable (220 V, 25 m), Solar panels (370 W), USB sockets (in cabins)

PRICE / WEEKS

25.04. - 02.05.2026 Booked	02.05. - 09.05.2026 Booked	09.05. - 16.05.2026 1.225 € 1.750 €	16.05. - 23.05.2026 1.225 € 1.750 €
23.05. - 30.05.2026 1.785 € 2.550 €	30.05. - 06.06.2026 Booked	06.06. - 13.06.2026 2.135 € 3.050 €	13.06. - 20.06.2026 2.135 € 3.050 €
20.06. - 27.06.2026 2.379 € 3.050 €	27.06. - 11.07.2026 Booked	11.07. - 18.07.2026 2.769 € 3.550 €	18.07. - 25.07.2026 Booked
25.07. - 01.08.2026 Booked	01.08. - 08.08.2026 Booked	08.08. - 15.08.2026 2.769 € 3.550 €	15.08. - 22.08.2026 2.769 € 3.550 €
22.08. - 29.08.2026 2.769 € 3.550 €	29.08. - 05.09.2026 2.769 € 3.550 €	05.09. - 12.09.2026 2.652 € 3.400 €	12.09. - 19.09.2026 2.652 € 3.400 €
19.09. - 26.09.2026 Booked	26.09. - 03.10.2026 1.989 € 2.550 €	03.10. - 10.10.2026 1.365 € 1.750 €	10.10. - 17.10.2026 1.170 € 1.500 €
17.10. - 24.10.2026 Booked	24.10. - 31.10.2026 1.170 € 1.500 €	31.10. - 07.11.2026 1.170 € 1.500 €	



WEB

najachty.pl

PHONE

+48 882 071 532

E-MAIL

biuro@najachty.pl

NAJACHTY

ul. Pi. Świętej Małgorzaty 1-2/42B, 58-100, Świdnica, Poland



PRICE / WEEKS

08.11. - 26.03.2027

Booked



WEB

najachty.pl

PHONE

+48 882 071 532

E-MAIL

biuro@najachty.pl

NAJACHTY

ul. Pi. Świętej Małgorzaty 1-2/42B, 58-100, Świdnica, Poland

