

EXCESS 11

One Kiss

The Catamaran Excess 11 „One Kiss“, built in 2024, is moored in Lefkas main port, Lefkas - Greece. The yacht has 4 + 2 cabins, can accommodate 8 + 2 persons and has 2 toilets/showers.



YACHT SPECIFICATIONS

Charter Base

Lefkas main port, Greece

Yacht ID

7422

Brand

Excess

Name

One Kiss

Production Year

2024

Length

11.42 m

Cabins

4 + 2

Berths

8 + 2

Head/Shower

2

STANDARD YACHT EQUIPMENT

Comfort

Bed linen, Blankets, Cockpit cushions, Pillows, Towels

Deck

Bilge pump - Mechanic, Black ball, Boat hook, Bosun's chair (Safe seat) (boatswain's chair), Cockpit/stern, outside shower, Dinghy, Electric anchor windlass, Fenders, Fuel funnel, Gangway, Jerry cans for fuel, Main anchor, Mooring ropes, Outboard engine, Plastic bucket, Spare anchor (Reserve, Auxiliary anchor), Swimming ladder, Water hose

Entertainment

Outdoor speakers, Radio, Snorkeling equipment

Galley

Gas cookers, Hot water, Kitchen utensils (Galley equipment, cutlery), Refrigerator, Stove

Interior

Barometer, Clock, Electric toilet, Yacht documents

Navigation

Autopilot, Binoculars, Compass, Divider, nautic chart, Echosounder/Depthsounder, GPS chart plotter - cockpit, Hand bearing compass, Nautical charts, Parallel ruler, Pilot book, Radar reflector, Speedometer (Speed log), Wind instrument/Anemometer

Safety

Distress flare box, Emergency tiller, Engine spare parts, Fire extinguisher, First aid kit, Floating light, Fog horn, Horseshoe lifebuoy, Life belts (Safety harness), Life jackets, Liferaft, Oars (Paddles), Repair kit, Set of tools, Torch, VHF radio, Wire (shroud) cutter

Sails

Electric winch, Lazy bag, Lazy jacks

Yacht electrics

Battery charger, Bilge pump - Electric, Shore connection 220 V, Solar panels

PRICE / WEEKS

25.04. - 02.05.2026 3.060 € 3.600 €	02.05. - 09.05.2026 3.440 € 4.300 €	09.05. - 16.05.2026 3.440 € 4.300 €	16.05. - 23.05.2026 3.440 € 4.300 €
23.05. - 30.05.2026 4.240 € 5.300 €	30.05. - 06.06.2026 4.770 € 5.300 €	06.06. - 13.06.2026 4.770 € 5.300 €	13.06. - 20.06.2026 5.265 € 5.850 €
20.06. - 27.06.2026 Booked	27.06. - 04.07.2026 Booked	04.07. - 11.07.2026 6.210 € 6.900 €	11.07. - 18.07.2026 6.210 € 6.900 €
18.07. - 25.07.2026 6.210 € 6.900 €	25.07. - 01.08.2026 6.210 € 6.900 €	01.08. - 08.08.2026 7.020 € 7.800 €	08.08. - 15.08.2026 7.020 € 7.800 €
15.08. - 22.08.2026 7.020 € 7.800 €	22.08. - 29.08.2026 Booked	29.08. - 05.09.2026 Booked	05.09. - 12.09.2026 5.985 € 6.650 €
12.09. - 19.09.2026 Booked	19.09. - 26.09.2026 5.760 € 6.400 €	26.09. - 03.10.2026 4.500 € 5.000 €	03.10. - 10.10.2026 4.185 € 4.650 €
10.10. - 17.10.2026 3.690 € 4.100 €	17.10. - 24.10.2026 3.150 € 3.500 €	24.10. - 31.10.2026 3.150 € 3.500 €	31.10. - 07.11.2026 3.150 € 3.500 €

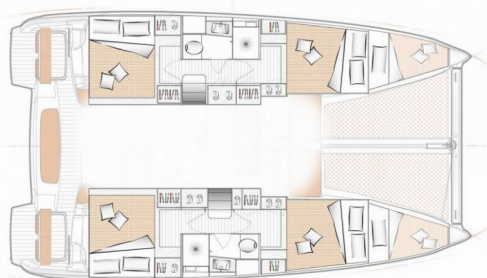

WEB

najachty.pl

PHONE

+48 882 071 532

E-MAIL

biuro@najachty.pl

NAJACHTY

ul. Pi. Świętej Małgorzaty 1-2/42B, 58-100, Świdnica, Poland



PRICE / WEEKS

07.11. - 14.11.2026

3.150 € ~~3.500 €~~

14.11. - 21.11.2026

3.150 € ~~3.500 €~~

21.11. - 31.12.2026

Booked

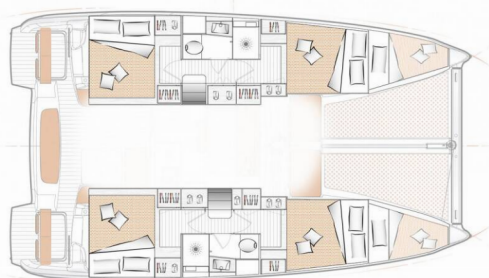

WEB

najachty.pl

PHONE

+48 882 071 532

E-MAIL

biuro@najachty.pl

NAJACHTY

ul. Pi. Świętej Małgorzaty 1-2/42B, 58-100, Świdnica, Poland

