

# LAGOON 400 S2

Vicky

The Catamaran Lagoon 400 S2 „Vicky“, built in 2016, is moored in Lefkas, D-Marin, Lefkas - Greece. The yacht has 4 + 2 cabins, can accommodate 8 + 2 persons and has 4 + 1 toilets/showers.

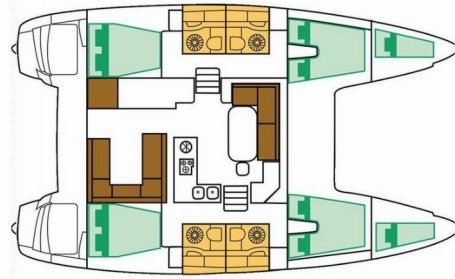

## YACHT SPECIFICATIONS

Charter Base

**Lefkas, D-Marin, Greece**

Yacht ID

**634**

Brand

**Lagoon-Bénéteau**

Name

**Vicky**

Production Year

**2016**

Length

**11.97 m**

Cabins

**4 + 2**

Berths

**8 + 2**

Max. Passengers

**10**

Head/Shower

**4 + 1**

## STANDARD YACHT EQUIPMENT

Comfort

Bedlinen and towels, Cockpit cushions, Pillows

Deck

Bimini top, Black ball, Boat hook, Dinghy with outboard engine, Electric anchor windlass, Hydraulic gangway, Main anchor, Spare anchor (Reserve, Auxiliary anchor), Sprayhood, Swimming ladder, Water hose, Winch handles

Entertainment

Snorkeling equipment

Galley

Gas cookers, Hot water, Kitchen utensils (Galley equipment, cutlery), Refrigerator, Stove

Interior

Barometer, Electric toilet

Navigation

Autopilot, Binoculars, GPS chart plotter - cockpit, Hand bearing compass, Log, Speed, Depth- echo sounder, Nautical charts, Pilot book, Wind instrument/Anemometer

Safety

Emergency tiller, Fire extinguisher, First aid kit, Fog horn, Life belts (Safety harness), Life jackets, Liferaft, Light and rope for horseshoe life buoy, Torch, VHF radio, Wire (shroud) cutter

Sails

Electric winch, Lazy bag, Lazy jacks

Yacht electrics

Air Conditioning, Battery charger, Generator, Shore connection 220 V, Solar panels, USB sockets

## PRICE / WEEKS

|   |   |   |   |
|---|---|---|---|
| 02.01. - 22.03.2025<br>Booked                     | 22.03. - 29.03.2025<br>2.340 € <del>2.600 €</del> | 29.03. - 05.04.2025<br>2.340 € <del>2.600 €</del> | 05.04. - 12.04.2025<br>2.210 € <del>2.600 €</del> |
| 12.04. - 19.04.2025<br>2.210 € <del>2.600 €</del> | 19.04. - 26.04.2025<br>2.210 € <del>2.600 €</del> | 26.04. - 03.05.2025<br>3.060 € <del>3.600 €</del> | 03.05. - 10.05.2025<br>3.400 € <del>4.000 €</del> |
| 10.05. - 17.05.2025<br>3.400 € <del>4.000 €</del> | 17.05. - 24.05.2025<br>3.400 € <del>4.000 €</del> | 24.05. - 31.05.2025<br>4.335 € <del>5.100 €</del> | 31.05. - 07.06.2025<br>4.590 € <del>5.100 €</del> |
| 07.06. - 14.06.2025<br>Booked                     | 14.06. - 21.06.2025<br>5.040 € <del>5.600 €</del> | 21.06. - 28.06.2025<br>6.210 € <del>6.900 €</del> | 28.06. - 05.07.2025<br>6.210 € <del>6.900 €</del> |

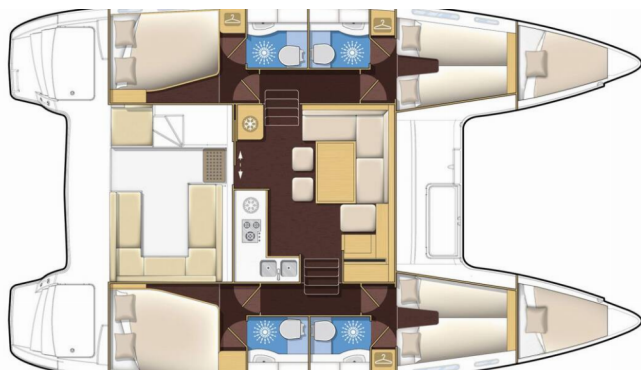

### WEB

najachty.pl

### PHONE

+48 882 071 532

### E-MAIL

biuro@najachty.pl

### NAJACHTY

ul. Pi. Świętej Małgorzaty 1-2/42B, 58-100, Świdnica, Poland



## PRICE / WEEKS

|   |   |   |   |
|---|---|---|---|
| 05.07. - 12.07.2025<br>6.210 € <del>6.900 €</del> | 12.07. - 19.07.2025<br>6.210 € <del>6.900 €</del> | 19.07. - 26.07.2025<br>6.210 € <del>6.900 €</del> | 26.07. - 02.08.2025<br>Booked                     |
| 02.08. - 09.08.2025<br>7.335 € <del>8.150 €</del> | 09.08. - 16.08.2025<br>7.335 € <del>8.150 €</del> | 16.08. - 23.08.2025<br>7.335 € <del>8.150 €</del> | 23.08. - 30.08.2025<br>6.210 € <del>6.900 €</del> |
| 30.08. - 06.09.2025<br>6.210 € <del>6.900 €</del> | 06.09. - 13.09.2025<br>6.210 € <del>6.900 €</del> | 13.09. - 20.09.2025<br>5.040 € <del>5.600 €</del> | 20.09. - 27.09.2025<br>5.040 € <del>5.600 €</del> |
| 27.09. - 04.10.2025<br>Booked                     | 04.10. - 11.10.2025<br>Booked                     | 11.10. - 18.10.2025<br>3.280 € <del>4.100 €</del> | 18.10. - 25.10.2025<br>3.000 € <del>3.750 €</del> |
| 25.10. - 01.11.2025<br>3.000 € <del>3.750 €</del> | 01.11. - 08.11.2025<br>3.000 € <del>3.750 €</del> | 08.11. - 15.11.2025<br>3.000 € <del>3.750 €</del> | 15.11. - 22.11.2025<br>3.375 € <del>3.750 €</del> |
| 22.11. - 29.11.2025<br>3.375 € <del>3.750 €</del> | 29.11. - 06.12.2025<br>3.375 € <del>3.750 €</del> | 06.12. - 13.12.2025<br>3.375 € <del>3.750 €</del> | 13.12. - 20.12.2025<br>3.375 € <del>3.750 €</del> |
| 20.12. - 27.12.2025<br>3.375 € <del>3.750 €</del> |   |   |   |

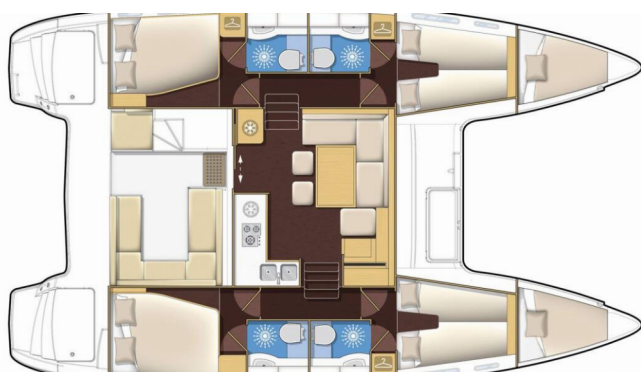

### WEB

najachty.pl

### PHONE

+48 882 071 532

### E-MAIL

biuro@najachty.pl

### NAJACHTY

ul. Pi. Świętej Małgorzaty 1-2/42B, 58-100, Świdnica, Poland

