

# BALI 4.2 OW

Dorothea

The Catamaran Bali 4.2 OW „Dorothea“, built in 2024, is moored in BVI, Tortola, Nanny Cay Marina, - British Virgin Islands. The yacht has 3 + 1 cabins, can accommodate 6 + 2 + 1 persons and has 3 toilets/showers.

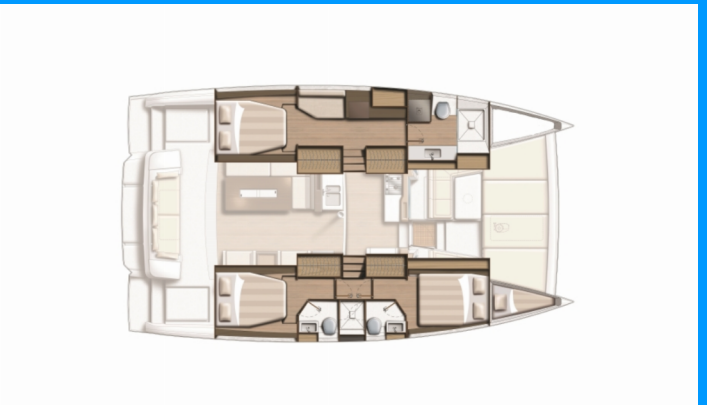

## YACHT SPECIFICATIONS

Charter Base

**BVI, Tortola, Nanny Cay Marina, British Virgin Islands**

Yacht ID

**6152**

Brand

**Catana**

Name

**Dorothea**

Production Year

**2024**

Length

**12.85 m**

Cabins

**3 + 1**

Berths

**6 + 2 + 1**

Max. Passengers

**9**

Head/Shower

**3**

## STANDARD YACHT EQUIPMENT

Comfort

Beach towel, Cockpit seat cushions with backrest, Deck cushions, Extra Bath Towels, Pillows, Salon cushions, Sheets

Deck

Anchor, Bimini top (Bimini Color modification: Marine Blue SUNTT 5031152 / NVEquipment Marine Blue A 00070), Black ball, Black conus, Boat hook, Canister for water, Chain counter on helm station, Cockpit/stern, outside shower, Deck brush, Dinghy with outboard engine (Highfield Ultra Light 340 Hypalon Charter Gris with YAMAHA engine 15 hp 2 stroke, short shaft. Electrical lift of the dinghy), Fenders, Grill/Barbecue/Plancha (Plancha with gas installation), Jerry cans for fuel, Mooring ropes, Plastic bucket, Swimming ladder, Water hose

Entertainment

FUSION sound system (Hifi Radio Fusion 4 HP bluetooth (Salon & Foredeck)), LED submarine lights (LED submarine lighting 21 W blue under each transom (4 spots)), Snorkeling equipment

Galley

Blender, Coffee machine, Dishwasher, Kitchen utensils (Galley equipment, cutlery), Microwave, Mug, Refrigerator (Fridge freezer 336L with chilled water), Toaster

Interior

Electric fans in cabins, Electric toilet (Electrical toilet with fresh water), Toilet brush

Navigation

AIS, Autopilot, Binoculars, GPS, GPS chart plotter, Nautical charts, Parallel ruler, Radar reflector, Windex

Safety

Buoyant smoke signal, Extra fuel tank (Extra fuel tank of 320L for a total capacity of 640L), Extra water tank ( Extra Fresh water tank of 400L for a total capacity of 860L), Fire blanket, Fire extinguisher, First aid kit, Flashlight, Fog horn, Horseshoe lifebuoy, Life jacket (children), Life jackets, Liferaft, Set of tools, Signaling mirror, Smoke detector, Torch, VHF radio

Sails

Electric mainsail windlass, Electric winch (Electrical winch (mainsail halyards, solent sheet, mainsheet, reefs and davits))

Yacht electrics

Air Conditioning (Reverse cycle aircond. in salon 120V/60Hz. Reverse cycle aircond. in hulls (3 cabins version) 120V/60 Hz), Battery charger (Combined battery charger 70 Amp), Generator (NL GENERATOR 9 KW 60HZ), Inverter ( Inverter 12V/230V - 1600VA), Isotherm boiler, Service batteries (2 extra service batteries of 130 amp), Solar panels (4X100W, 400W), Watermaker - desalinator (WATERMAKER 115V / 60Hz - High Output Naked - (100 - 140lph))

## PRICE / WEEKS

16.05. - 25.05.2026

Booked

25.05. - 04.06.2026

Booked

04.06. - 13.06.2026

Booked

25.06. - 04.07.2026

Booked

04.08. - 09.10.2026

Booked

23.10. - 01.11.2026

Booked

14.11. - 22.11.2026

Booked



### WEB

[najachty.pl](http://najachty.pl)

### PHONE

+48 882 071 532

### E-MAIL

[biuro@najachty.pl](mailto:biuro@najachty.pl)

### NAJACHTY

ul. Pi. Świętej Małgorzaty 1-2/42B, 58-100, Świdnica, Poland



## PRICE / WEEKS

01.12. - 07.12.2026

Booked

19.12. - 26.12.2026

5.444 € ~~5.730 €~~

26.12. - 02.01.2027

10.379 € ~~10.925 €~~



### WEB

[najachty.pl](http://najachty.pl)

### PHONE

+48 882 071 532

### E-MAIL

[biuro@najachty.pl](mailto:biuro@najachty.pl)

### NAJACHTY

ul. Pi. Świętej Małgorzaty 1-2/42B, 58-100, Świdnica, Poland

