

FONTAINE PAJOT SABA 50

Anna Isabella

The Catamaran Fountaine Pajot Saba 50 „Anna Isabella“, built in 2019, is moored in Seychelles, Eden Island Marina, - Seychelles. The yacht has 5 + 1 cabins, can accomodate 10 + 2 persons and has 6 toilets/showers.

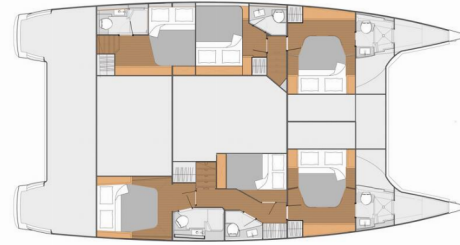

YACHT SPECIFICATIONS

Charter Base

**Seychelles, Eden Island Marina,
Seychelles**

Yacht ID

4863

Brand

Fountaine Pajot

Name

Anna Isabella

Production Year

2019

Length

14.98 m

Cabins

5 + 1

Berths

10 + 2

Head/Shower

6

STANDARD YACHT EQUIPMENT

Comfort

Bedlinen and towels, Cockpit cushions

Deck

Anchor with chain, Boat hook, Cockpit fridge (75l), Cockpit light, Cockpit table, Cockpit/stern, outside shower, Dinghy, Electric anchor windlass, Fenders, Grill/Barbecue/Plancha, Hard Top Bimini, Jerry cans for diesel, Outboard engine, Sun deck, Swimming ladder, Teak cockpit

Entertainment

Fishing equipment, FUSION sound system, Outdoor speakers, Stand up paddle (SUP), TV

Galley

Freezer, Gas bottles, Hot water, Kitchen utensils (Galley equipment, cutlery), Microwave, Refrigerator (190 L + additional 130 L)

Interior

Electric fans, Salon table

Navigation

Autopilot, GPS, Navigation (Nautical) charts and nautical guide, Navigation set

Safety

Black Water Tank, First aid kit, Life belts (Safety harness), Life jackets, Signal rockets and torches, VHF radio

Yacht electrics

Air Conditioning, Battery charger, Bilge pump - Electric, Fish finder, Generator, Heating, Inverter, Plug 220V, 12 V, Shore power connection, Solar panels, Watermaker - desalinator

PRICE / WEEKS

20.10. - 28.10.2026

Booked

31.10. - 08.11.2026

Booked

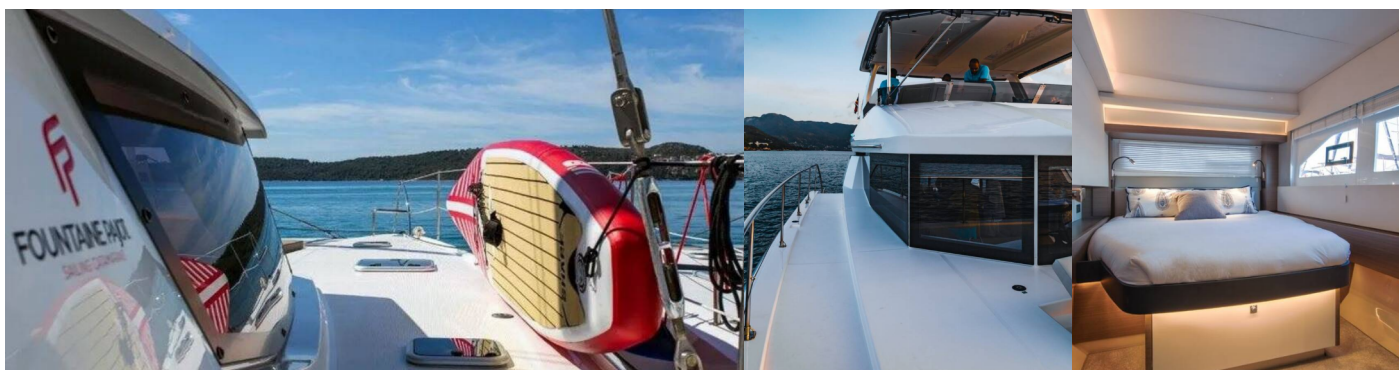

WEB

najachty.pl

PHONE

+48 882 071 532

E-MAIL

biuro@najachty.pl

NAJACHTY

ul. Pi. Świętej Małgorzaty 1-2/42B, 58-100, Świdnica, Poland



PRICE / WEEKS

11.11. - 19.11.2026

Booked

22.11. - 30.11.2026

Booked

03.12. - 11.12.2026

Booked

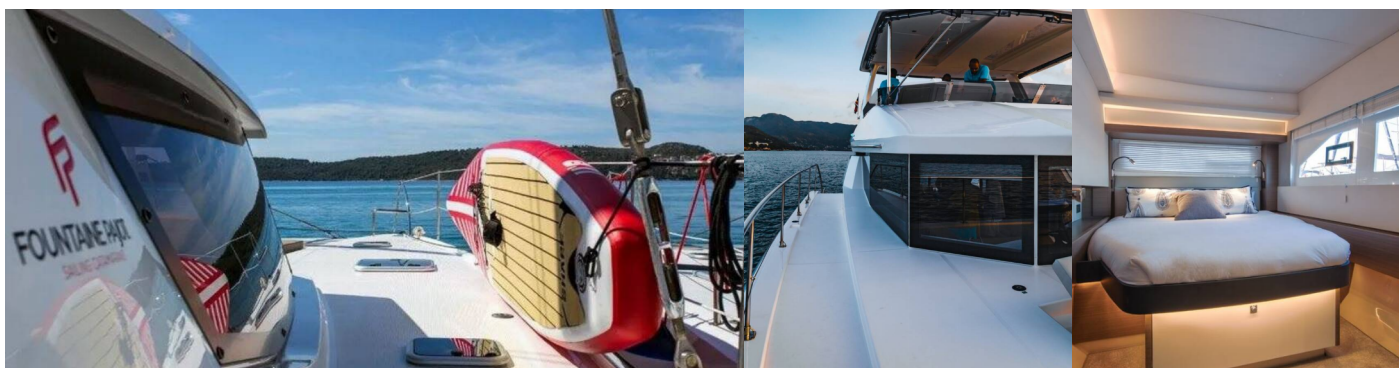

WEB

najachty.pl

PHONE

+48 882 071 532

E-MAIL

biuro@najachty.pl

NAJACHTY

ul. Pi. Świętej Małgorzaty 1-2/42B, 58-100, Świdnica, Poland

