

GREENLINE 45 FLY

Chili

The Motor yacht Greenline 45 Fly „Chili“, built in 2023, is moored in Marina Kornati, Biograd, Biograd - Croatia. The yacht has 3 cabins, can accommodate 6 + 2 persons and has 2 toilets/showers.

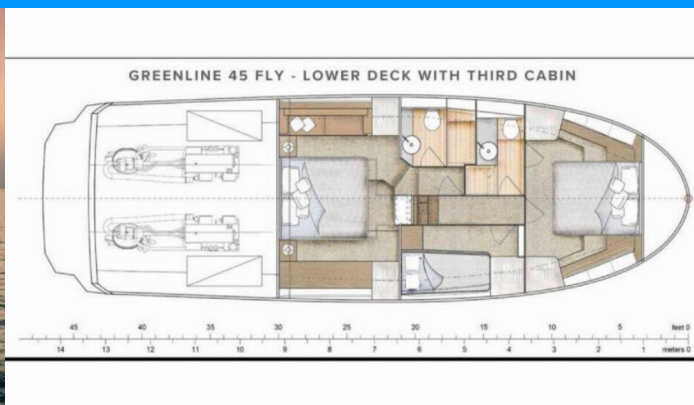

YACHT SPECIFICATIONS

Charter Base

Marina Kornati, Biograd, Croatia

Yacht ID

4810

Brand

Greenline

Name

Chili

Production Year

2023

Length

15.57 m

Cabins

3

Berths

6 + 2

Head/Shower

2

STANDARD YACHT EQUIPMENT

Comfort

Cockpit seat cushions with backrest, Sun mattresses, Sundeck cushions

Deck

Anchor with chain (20kg + 50m), Bathing platform (teak), Bimini top, Cockpit grill (on Flybridge - electric), Cockpit table, Dinghy, Electric anchor windlass, Fenders, Fly sunbathing area, Flybridge (with biminitop), Fridge on flybridge, Main Deck Compass, Mooring ropes, Sea/Storm drogue anchor, Teak cockpit (Teak on cockpit floor, cockpit seats and bathing platform), Teak table (on Flybridge)

Entertainment

FUSION sound system (FUSION Marine Audio Package, remote control in cockpit, bluetooth, USB), Indoor speakers, Outdoor speakers, Underwater lights (LED)

Galley

Dishwasher, Freezer, Hot water, Microwave, Refrigerator (full size fridge including freezer compartment in galley), Sink (on Flybridge), Stove (2 burner induction stove)

Interior

Convertible table in salon, Electric toilet (Quiet), LED lights (ambient light)

Navigation

Autopilot (Raymarine EV-200), Bow thruster, Docking camera (Raymarine camera/cockpit/rear view), GPS chart plotter (Raymarine Axiom 16" GPS at helmstation and flybridge), Hand bearing compass, Harbour guides, Navigation (Nautical) charts and nautical guide, Navigation/position Lights, Radar (4kW Quantum Radome), Stern thruster (6,3kW with 2 x 100 Ah)

Safety

Black Water Tank, Distress flare box, Fire extinguisher, First aid kit, Fog horn, Life jackets, Set of tools, Signal rockets and torches, VHF radio (Raymarine Ray90)

Yacht electrics

Air Conditioning (Reverse cycle, 4 units (saloon, cabins), 46000 BTU, 230V), Batteries (AGM), Generator ((diesel) 11kW/50Hz), Heating, Inverter (12V/220V), Shore connection 220 V, Solar charger (Solar battery charge management system), Solar panels (2 x Photovoltaic panels integrated in the coachroof, 600 W, 12V)

PRICE / WEEKS

25.04. - 02.05.2026 5.400 € 7.200 €	02.05. - 09.05.2026 5.400 € 7.200 €	09.05. - 16.05.2026 5.400 € 7.200 €	16.05. - 23.05.2026 5.400 € 7.200 €
23.05. - 30.05.2026 6.300 € 8.400 €	30.05. - 06.06.2026 Booked	06.06. - 13.06.2026 Booked	13.06. - 20.06.2026 9.180 € 10.200 €
20.06. - 27.06.2026 9.810 € 10.900 €	27.06. - 04.07.2026 Booked	04.07. - 11.07.2026 Booked	11.07. - 01.08.2026 Booked
01.08. - 08.08.2026 11.520 € 12.800 €	08.08. - 15.08.2026 Booked	15.08. - 22.08.2026 Booked	22.08. - 29.08.2026 Booked
29.08. - 05.09.2026 Booked	05.09. - 12.09.2026 7.560 € 8.400 €	12.09. - 19.09.2026 Booked	19.09. - 03.10.2026 Booked
03.10. - 10.10.2026 Booked	10.10. - 17.10.2026 5.580 € 6.200 €	17.10. - 24.10.2026 5.580 € 6.200 €	25.10. - 31.12.2026 Booked



WEB

najachty.pl

PHONE

+48 882 071 532

E-MAIL

biuro@najachty.pl

NAJACHTY

ul. Pi. Świętej Małgorzaty 1-2/42B, 58-100, Świdnica, Poland

