

AQUILA 44

Gr8 Day (Social Distancing II)

The Power catamaran Aquila 44 „Gr8 Day (Social Distancing II)“, built in 2018, is moored in Marsh Harbour, Conch Inn Marina, - Bahamas. The yacht has 3 cabins, can accomodate 8 persons and has 3 toilets/showers.

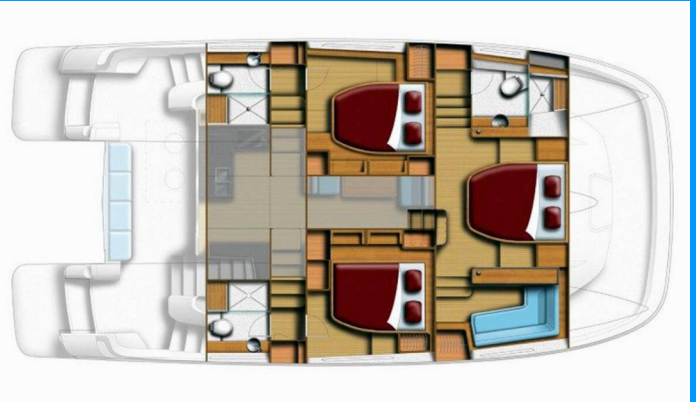

YACHT SPECIFICATIONS

Charter Base

**Marsh Harbour, Conch Inn Marina,
Bahamas**

Yacht ID

3403

Brand

Aquila Yachts

Name

Gr8 Day (Social Distancing II)

Production Year

2018

Length

13.70 m

Cabins

3

Berths

8

Max. Passengers

8

Head/Shower

3

STANDARD YACHT EQUIPMENT

Comfort

Mattresses (Sizes: Forward Master: 71"W x 79"L (180cm x 200cm) Aft Stbd & Port: 59"W x 79"L (150cm x 200cm))

Deck

Aft lounge area (Aft cockpit seating with U-Shaped settee with integrated cup holders, coolerbox and table (converts into sun bathing area - most models)), Cockpit/stern, outside shower (Cockpit shower, hot and cold water), Dinghy with outboard engine (AB 12ft with Yamaha 15 HP), Electric anchor windlass (Anchor locker with 1500 watt windlass; handheld remote with custom chain lock), Flybridge (Flybridge table with fold down extensions comfortably seating six people), Foredeck sunbathing area (foredeck for sunbathing LED down lighting in aft cockpit), Swimming ladder

Entertainment

Radio (Entertainment system remote control located next to helm • Marine waterproof speakers), Wet bar (Flybridge - Wet bar behind helm station incorporating corian work surface, sink with hot and cold faucet)

Galley

Electrical filter coffee maker, Freezer (Freezer 2 drawer front access offering easy access and efficient packing), Microwave (120V or 220V (Inverter option as power source required)), Refrigerator (Freezer 2 drawer front access offering easy access and efficient packing), Sink (Double stainless-steel sink with corian worktop cover and single lever variable temperature faucet), Stove (Two burner electric stove)

Interior

Convertible table in salon (Salon converts into 1x comfortable single bed), Electric toilet, LED interior lights (Overhead LED ceiling lights, LED mood lighting and LED courtesy lighting), Salon (Settee seating U-shape around salon table seats 6), Salon table

Navigation

Autopilot, Compass, GPS chart plotter (Chartplotter on flybridge plus seatalk backbone cable kit), Navigation/position Lights (LED navigation lights - port, starboard, stern, anchor & running light)

Safety

VHF radio (VHF with raymicrophone remote station for flybridge and antennae)

Yacht electrics

Air Conditioning, Generator, Shore connection 220 V (Shore side electrical system 110V), Solar panels (Solar Panels (2 X 55W) on hardtop), Watermaker - desalinator