

# OCEANIS 51.1

Jupiter

The Sailing yacht Oceanis 51.1 „Jupiter“, built in 2020, is moored in Marina Šangulin, Biograd, - Croatia. The yacht has 5 + 1 cabins, can accomodate 10 + 1 + 1 persons and has 3 toilets/showers.

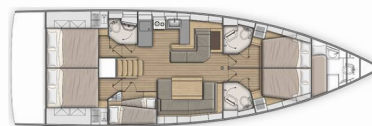

## YACHT SPECIFICATIONS

Charter Base

**Marina Sangulin, Biograd, Croatia**

Yacht ID

**2690**

Brand

**Bénéteau**

Name

**Jupiter**

Production Year

**2020**

Length

**15.94 m**

Cabins

**5 + 1**

Berths

**10 + 1 + 1**

Max. Passengers

**12**

Head/Shower

**3**

## STANDARD YACHT EQUIPMENT

Comfort

Bed linen, Cockpit cushions, Mosquito nets, Pillows

Deck

Anchor Delta (20 kg), Anchor Jambo (10 kg), Bathing platform, Bilge pump - Mechanic, Bimini top (new 2024), Boat hook, Cockpit grill, Cockpit table (built in 15L cool box), Cockpit/stern, outside shower, Dinghy (2,40m), Electric anchor windlass, Fenders (8 + 1), Gangway, Main anchor, Mooring ropes , Sprayhood, Teak cockpit (floor & trasom), Teak seats in cockpit, Water hose, Winch handles

Entertainment

Fusion radio, Outdoor speakers

Galley

Electrical kettle, Gas bottles, Gas cookers, Hot water, Kitchen utensils (Galley equipment, cutlery), Moka pot, Oven (gas), Refrigerator, Sink

Interior

Barometer, Bunk bed, Clock, Duvet cover, Electric fans in cabins, Electric toilet

Navigation

Autopilot (Raymarine P70S), Binoculars, Bow thruster, Compass, Divider, nautic chart, GPS chart plotter - cockpit (Raymarine Axiom 7 ), Hand bearing compass, Navigation (Nautical) charts and nautical guide , Navigation set, Radar reflector, Tridata (Raymarine i70), Wind instrument/Anemometer (Raymarine i70)

Safety

Black Water Tank, Distress flare box, Emergency tiller, Fire extinguisher , First aid kit , Flashlight, Fog horn, Life belts (Safety harness), Life buoy + Flashing light, Life jackets, Liferaft , Repair kit, Set of tools , VHF radio (Ray53, AIS)

Sails

Winch

Yacht electrics

220V socket, Air Conditioning (in salon (shore power only)), Battery charger , Bilge pump - Electric, Heating, Pump, Service batteries (3 x 140 Ah), Shore connection 220 V, Shore power cable

## PRICE / WEEKS

01.01. - 14.03.2025 Booked	15.03. - 22.03.2025 2.419 € <del>3.024 €</del>	22.03. - 29.03.2025 2.419 € <del>3.024 €</del>	29.03. - 05.04.2025 2.419 € <del>3.024 €</del>
05.04. - 12.04.2025 2.419 € <del>3.024 €</del>	12.04. - 19.04.2025 2.419 € <del>3.024 €</del>	19.04. - 26.04.2025 2.995 € <del>3.744 €</del>	26.04. - 03.05.2025 Booked
03.05. - 10.05.2025 3.241 € <del>4.051 €</del>	10.05. - 17.05.2025 3.387 € <del>4.234 €</del>	17.05. - 24.05.2025 3.748 € <del>4.685 €</del>	24.05. - 31.05.2025 4.960 € <del>6.200 €</del>
31.05. - 07.06.2025 5.328 € <del>6.660 €</del>	07.06. - 14.06.2025 5.440 € <del>6.800 €</del>	14.06. - 21.06.2025 6.014 € <del>7.517 €</del>	21.06. - 28.06.2025 6.359 € <del>7.949 €</del>
28.06. - 05.07.2025 6.712 € <del>8.390 €</del>			

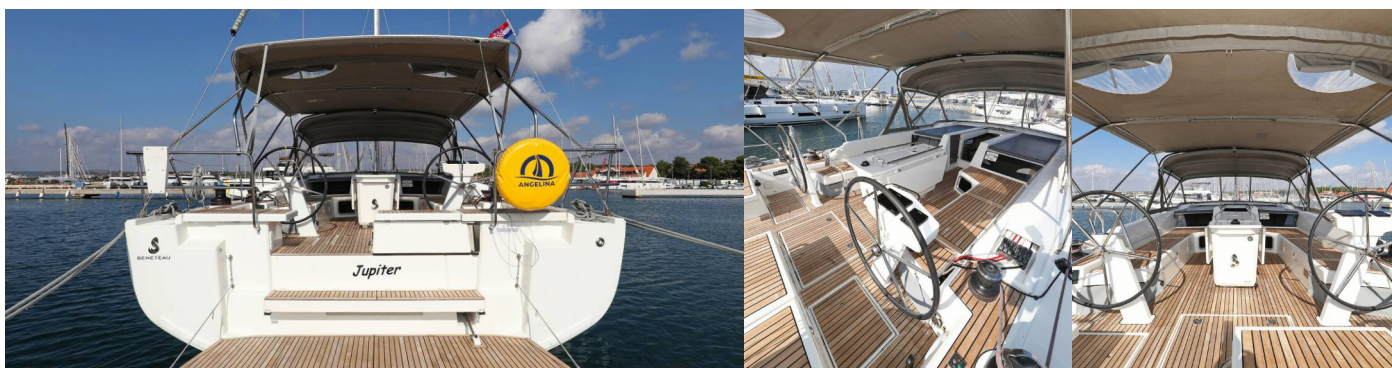

### WEB

najachty.pl

### PHONE

+48 882 071 532

### E-MAIL

biuro@najachty.pl

### NAJACHTY

ul. Pi. Świętej Małgorzaty 1-2/42B, 58-100, Świdnica, Poland



## PRICE / WEEKS

05.07. - 12.07.2025 6.758 € <del>8.448 €</del>	12.07. - 19.07.2025 6.758 € <del>8.448 €</del>	19.07. - 26.07.2025 6.758 € <del>8.448 €</del>	26.07. - 02.08.2025 6.797 € <del>8.496 €</del>
02.08. - 09.08.2025 6.797 € <del>8.496 €</del>	09.08. - 16.08.2025 6.528 € <del>8.160 €</del>	16.08. - 23.08.2025 6.174 € <del>7.718 €</del>	23.08. - 30.08.2025 5.998 € <del>7.498 €</del>
30.08. - 06.09.2025 6.273 € <del>7.380 €</del>	06.09. - 13.09.2025 6.120 € <del>7.200 €</del>	13.09. - 20.09.2025 4.616 € <del>5.430 €</del>	20.09. - 27.09.2025 3.723 € <del>4.380 €</del>
27.09. - 04.10.2025 3.630 € <del>4.270 €</del>	04.10. - 11.10.2025 2.699 € <del>3.175 €</del>	11.10. - 18.10.2025 3.158 € <del>3.715 €</del>	18.10. - 25.10.2025 2.913 € <del>3.427 €</del>
25.10. - 01.11.2025 2.856 € <del>3.360 €</del>	01.11. - 08.11.2025 2.688 € <del>3.360 €</del>	10.11. - 13.03.2026 Booked	

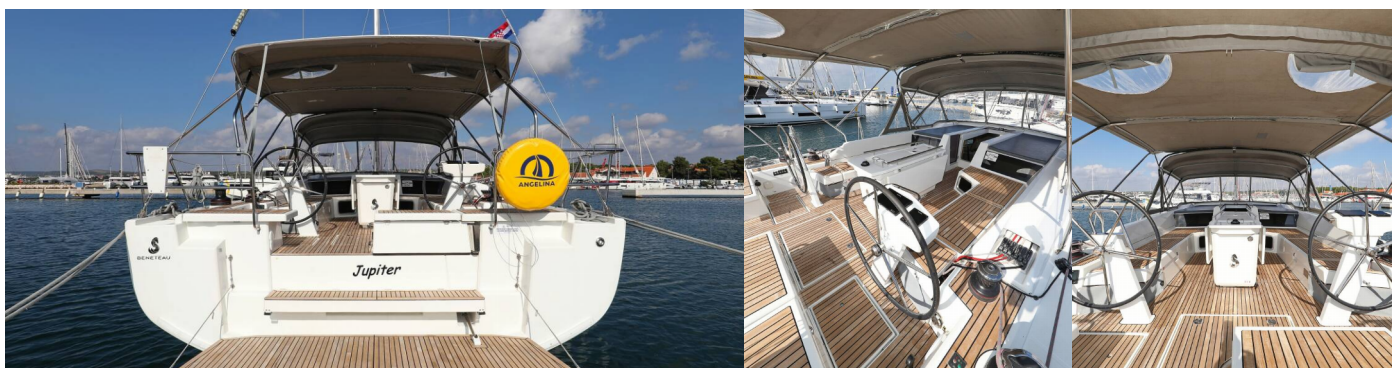

### WEB

najachty.pl

### PHONE

+48 882 071 532

### E-MAIL

biuro@najachty.pl

### NAJACHTY

ul. Pi. Świętej Małgorzaty 1-2/42B, 58-100, Świdnica, Poland

