

BALI 5.2

ANCHI

The Catamaran Bali 5.2 „ANCHI“, built in 2026, is moored in Polynesia, Raiatea, - French Polynesia. The yacht has 6 + 2 cabins, can accommodate 12 + 2 persons and has 6 + 2 toilets/showers.

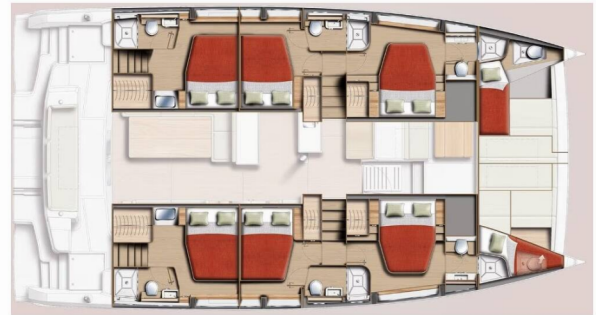

YACHT SPECIFICATIONS

Charter Base

Polynesia, Raiatea, French Polynesia

Yacht ID

10309

Brand

Catana

Name

ANCHI

Production Year

2026

Length

15.90 m

Cabins

6 + 2

Berths

12 + 2

Max. Passengers

14

Head/Shower

6 + 2

STANDARD YACHT EQUIPMENT

Comfort

Cockpit cushions

Deck

Cockpit table, Cockpit/stern, outside shower, Electric anchor windlass, Grill/Barbecue/Plancha, Remote control for anchor winch with chain counter at helm, Swimming ladder

Entertainment

Fusion radio

Galley

Kitchen utensils (Galley equipment, cutlery), Oven, Refrigerator, Stove

Interior

Electric fans, Electric toilet

Navigation

AIS, Autopilot, GPS chart plotter - cockpit, Wind/speed/depth instruments

Safety

VHF radio

Sails

Electric winch, Lazy bag, Lazy jacks

Yacht electrics

Air Conditioning, Battery monitor, Generator, Inverter, Solar panels (2577W), Watermaker - desalinator