

BAVARIA C42

Blue Eyes

The Sailing yacht Bavaria C42 „Blue Eyes“, built in 2024, is moored in Palma de Mallorca, Marina Naviera Balear, - Spain. The yacht has 3 cabins, can accomodate 6 persons and has 2 toilets/showers.

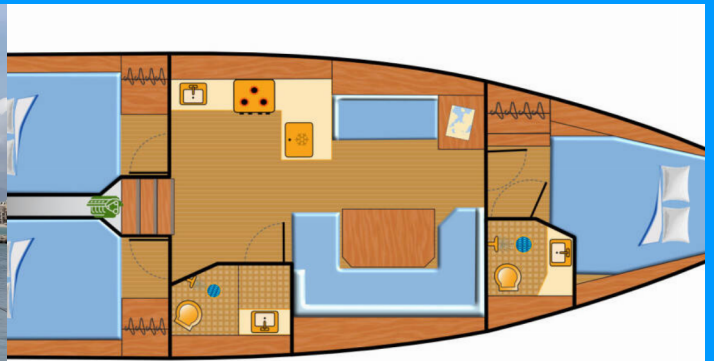

YACHT SPECIFICATIONS

Charter Base

**Palma de Mallorca, Marina Naviera
Balear, Spain**

Yacht ID

10127

Brand

Bavaria Yachtbau

Name

Blue Eyes

Production Year

2024

Length

12.40 m

Cabins

3

Berths

6

Head/Shower

2

STANDARD YACHT EQUIPMENT

Additional

Flag

Comfort

Cockpit cushions

Deck

Anchor light, Anchor with chain, Bathing platform (Teak), Bimini top, Boat hook, Bosun's chair (Safe seat) (boatswain's chair), Bow pulpit, Cockpit table, Cockpit/stern, outside shower, Deck brush, Dinghy, Electric anchor windlass, Fenders, Gangway, Jerry cans for diesel, Mooring ropes, Plastic bucket, Spare anchor (Reserve, Auxiliary anchor), Spotlight / Headlights, Sprayhood, Swimming ladder, Teak cockpit

Entertainment

Outdoor speakers, Radio CD mp3 player, Wi-Fi Internet

Galley

Hot water, Kitchen utensils (Galley equipment, cutlery), Oven, Pressurized water system, Refrigerator, Sink, Stove

Interior

Clock, Convertible table in salon (foldable), Heater / Blower, Safe, Yacht keys

Navigation

AIS (recipient), Autopilot, Binoculars, Bow thruster, Compass, Composite steering wheels, GPS, GPS chart plotter - cockpit, Log, Speed, Depth- echo sounder, Navigation (Nautical) charts and nautical guide, Navigation/position Lights, Triangles, Wind instrument/Anemometer, Windex

Safety

Black Water Tank, Distress signals, Emergency tiller, EPIRB-Distress radio beacons, Fire extinguisher, First aid kit, Flashlight, Fog horn, Guard rail, Life belts (Safety harness), Liferaft, Safety equipment, Set of tools, VHF radio, Wire (shroud) cutter

Sails

Halyard winches

Yacht electrics

12V Socket, 220V socket, Adapter, Battery charger, Bilge pump - Electric, Converter 230V/12V, Heating (Webasto), Shore power cable

PRICE / WEEKS

| | | | |
|---|---|---|---|
| 25.04. - 02.05.2026 2.025 € 2.700 € | 02.05. - 09.05.2026 Booked | 09.05. - 16.05.2026 2.625 € 3.500 € | 16.05. - 23.05.2026 2.625 € 3.500 € |
| 23.05. - 06.06.2026 Booked | 06.06. - 13.06.2026 3.225 € 4.300 € | 13.06. - 20.06.2026 3.225 € 4.300 € | 20.06. - 27.06.2026 Booked |
| 27.06. - 04.07.2026 Booked | 04.07. - 11.07.2026 4.165 € 4.900 € | 11.07. - 18.07.2026 Booked | 18.07. - 25.07.2026 4.165 € 4.900 € |
| 25.07. - 01.08.2026 4.165 € 4.900 € | 01.08. - 08.08.2026 4.165 € 4.900 € | 08.08. - 15.08.2026 Booked | 15.08. - 22.08.2026 4.165 € 4.900 € |
| 22.08. - 29.08.2026 4.165 € 4.900 € | 29.08. - 05.09.2026 4.165 € 4.900 € | 05.09. - 12.09.2026 3.910 € 4.600 € | 12.09. - 19.09.2026 Booked |
| 19.09. - 26.09.2026 Booked | 26.09. - 03.10.2026 Booked | 03.10. - 10.10.2026 2.975 € 3.500 € | 10.10. - 17.10.2026 2.975 € 3.500 € |
| 17.10. - 24.10.2026 2.295 € 2.700 € | 24.10. - 31.10.2026 Booked | 31.10. - 07.11.2026 2.295 € 2.700 € | |



WEB

najachty.pl

PHONE

+48 882 071 532

E-MAIL

biuro@najachty.pl

NAJACHTY

ul. Pi. Świętej Małgorzaty 1-2/42B, 58-100, Świdnica, Poland



PRICE / WEEKS

08.11. - 26.03.2027

Booked



WEB

najachty.pl

PHONE

+48 882 071 532

E-MAIL

biuro@najachty.pl

NAJACHTY

ul. Pi. Świętej Małgorzaty 1-2/42B, 58-100, Świdnica, Poland

